



GREEN SCHOOLS
CONFERENCE & EXPO



ROCKY MOUNTAIN GREEN

Expo Floor Plan Listing

101	Awair	304	Solargreen Technologies
102	Johnson Controls Inc.	305	KG Clean Inc.
103	Excel Dryer	306	1-800-Got-Junk?
104	2B Technologies, Inc. / AQTreks	307	Colorado Ready Mixed Concrete Association
105	Graybar	308	TerraCycle
106	Prihoda Recycled Fabric Duct and Diffusers	310	VS America
107	Tandus Flooring	401	Interface
108	Mohawk Group	402	VELUX - Commercial
109	Action Floors Systems	403	IES Ltd.
110	Nichiha	404	Hydropoint Data Systems
111	Group14 Engineering, PBC	405	BoardDocs
112	Buddy Platform	406	Apollo Solutions Group
113	Z Bioscience Inc.	407	Airthinx, Inc.
114	Belling-Wood Depot	408	Sustainable Forestry Initiative
115	Unify Energy Solutions	409	Sika Sarnafil
201	Green Schools National Network	410	Steel Recycling Institute
202	Center for Green Schools	411	ATS Rocky Mountain
203	PD Collaborative	412	Dow Building Solutions
204	Beyond Green Partners	414	International Society of Sustainability Professionals (ISSP)
205	Foodservice Sustainability Solutions (FSS)	416	Illumination Systems
206	Casio America	t501	Generation 180
208	JVA Inc.	t502	The Weidt Group
210	NV5, Inc.	t503	Carton Council
211	VMDO Architects	t504	Sustainability Institute for Educators
213	MEP Engineering	t505	U.S. Environmental Protection Agency (EPA) - Region 8
301	Bowman Construction Supply	t506	Building Commissioning Association - Southwest
302	U.S. Green Building Council	t507	Event Media Partners
303	Colorado Construction & Design	t508	Event Media Partners

ALL FLOOR PLANS ARE SUBJECT TO CHANGE AND ARE CURRENTLY PENDING FIRE MARSHAL / FACILITY APPROVAL.

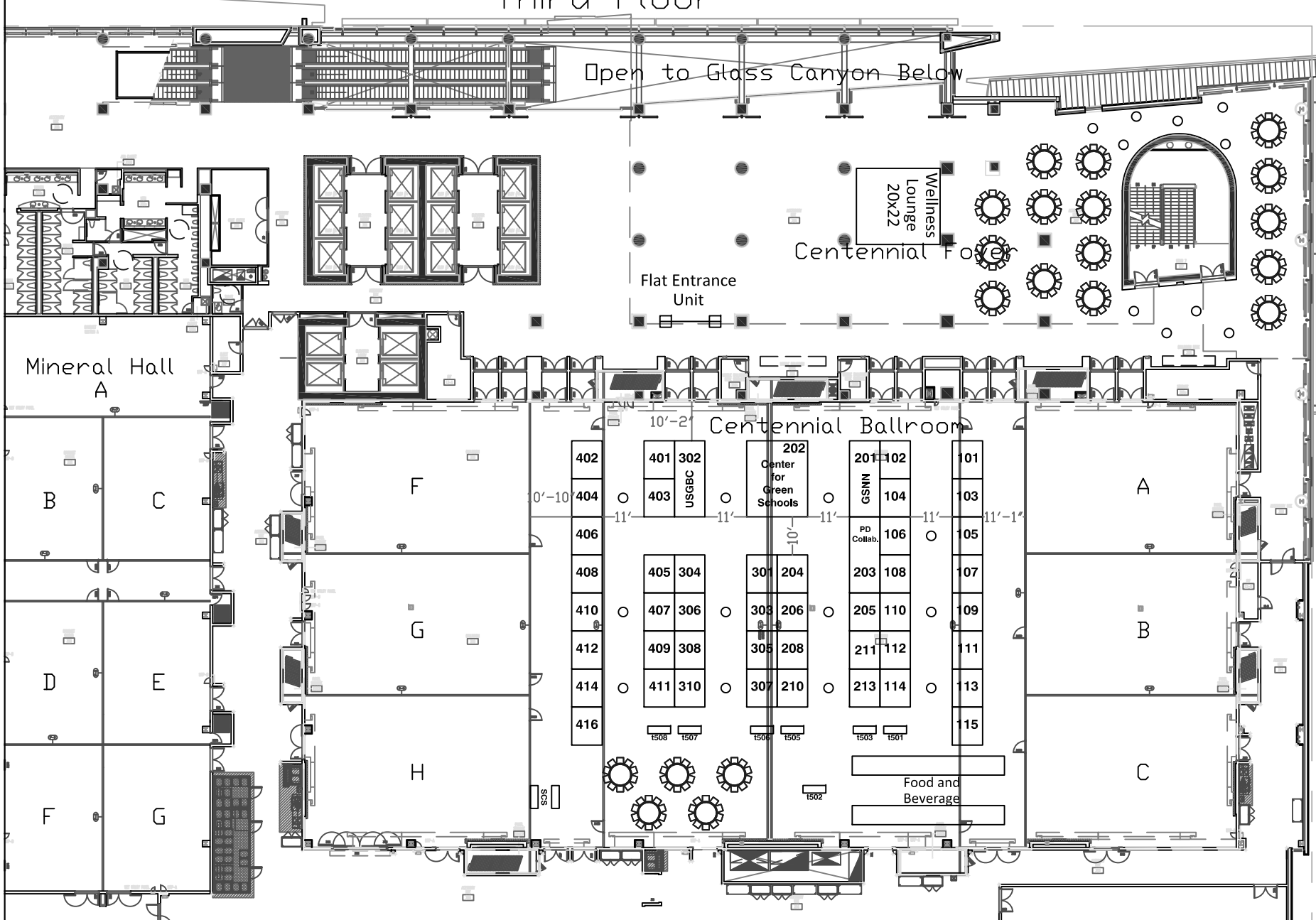

Green Schools 2018
Hyatt Regency Denver- Centennial Ballroom
D&E

Dwg. Name: Green Schools 2018
Dwg Date: 4.26.2018 By: JB Rev: 16 FMA: Pending
All Booths are 10' wide unless noted otherwise
All Aisles are 10' wide unless noted otherwise
Show Colors:



2900 Stayton Street, Pittsburgh PA 15212
PH: 412.223.1090 - FX: 412.223.1094
E-MAIL: ahawk@stetsonexpo.com

Booths

Dimensions	Quantity
8x10	45
8x20	3
16x20	1
6' Tables	7
Totals:	56

Disclaimer

Every effort has been made to ensure the accuracy of all information contained on this floor plan. However no warranties, either expressed or implied are made with respect to this floor plan. If the location of building columns, utilities of other architectural components of the facility is a consideration of construction or usage of an exhibit, it is the sole responsibility of the exhibitor to physically inspect the facility to verify all dimensions and locations.